

CONTRACT: DM00494 BRIDGE PROJECT: 18313.1011058.PR

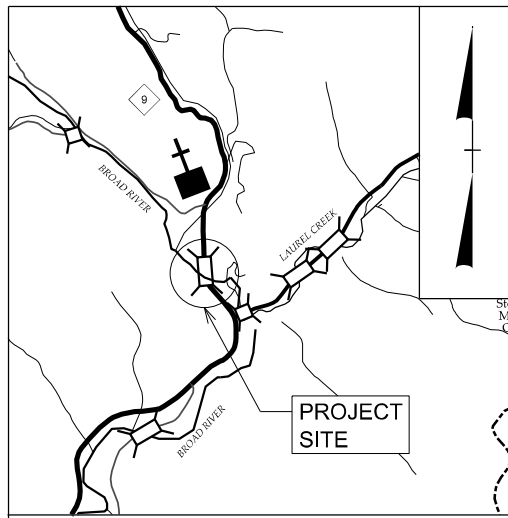

VICINITY MAP (NTS)

STATE OF NORTH CAROLINA
DIVISION OF HIGHWAYS

BUNCOMBE COUNTY

LOCATION: REPAIR BRIDGE #100079 ON NC 9 OVER BROAD RIVER

TYPE OF WORK: STRUCTURE REPAIRS

STATE	STATE PROJECT REFERENCE NO.	SHEET NO.	TOTAL SHEETS
N.C.	18313.1011058.PR		
STATE PROJ. NO.	F. A. PROJ. NO.	DESCRIPTION	
18313.1011058.PR	N/A	CONSTRUCTION	

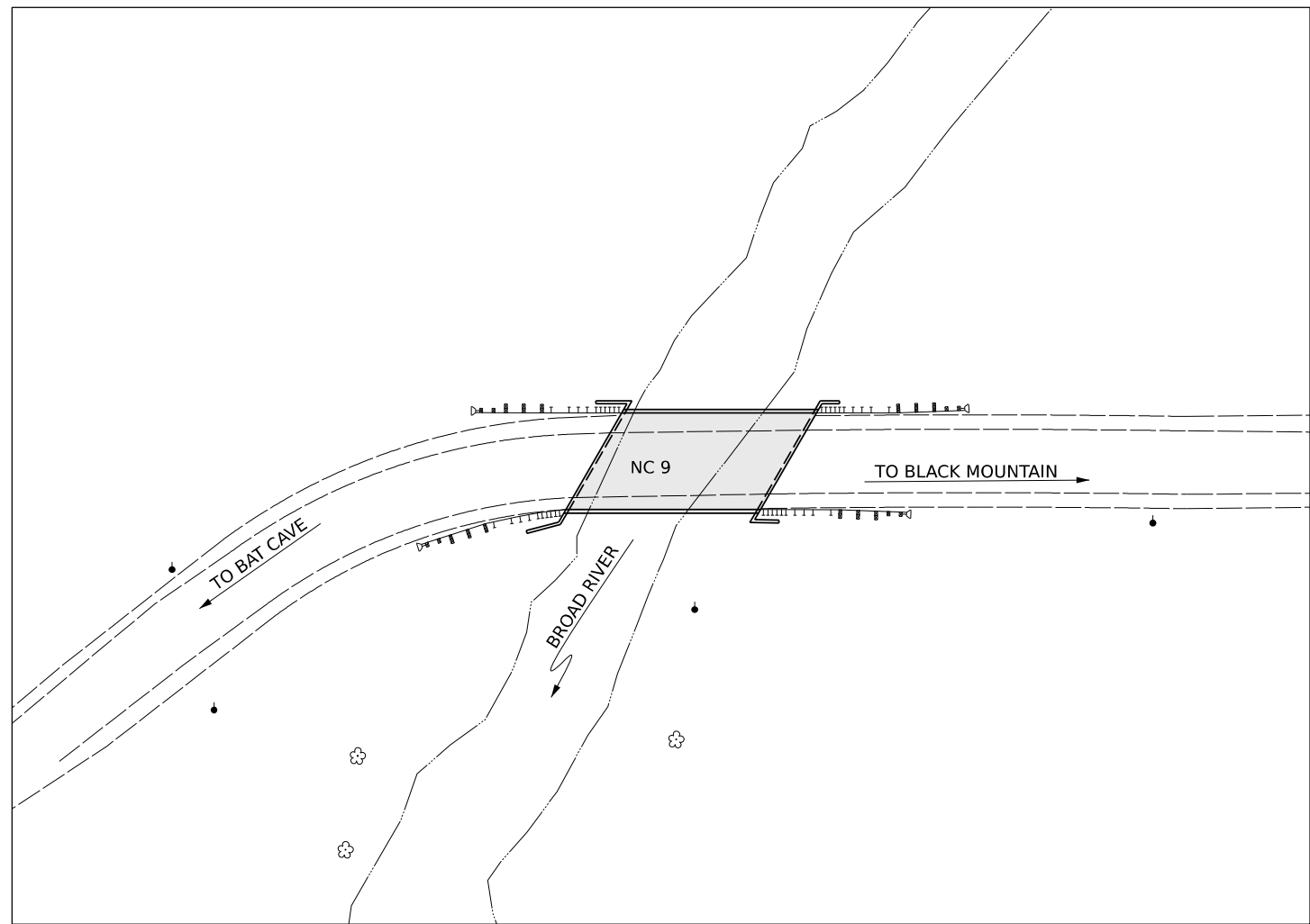
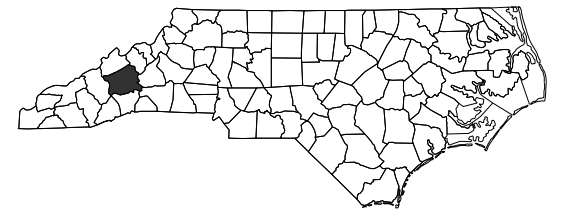

DOCUMENT NOT CONSIDERED FINAL
UNLESS ALL SIGNATURES COMPLETED

DESIGN DATA
 ADT 2019 = 800
 ADT 2040 = 1600

 V = 30 MPH
 * TTST = DUAL
 FUNC CLASS = RURAL
 MAJOR COLLECTOR
 REGIONAL TIER

PROJECT LENGTH
 PROJECT LENGTHS FOR BRIDGE PROJECT 18313.1011058.PR:
 TOTAL LENGTH PROJECT 18313.1011058.PR = 0.013 MILES

NCDOT Contact: JOEL M. DAVIS
 Prepared in the Office of:  VHB Engineering NC, P.C. (C-3705)
 640 Main Campus Drive, Suite 500
 Raleigh, NC 27606

 2024 STANDARD SPECIFICATIONS

 W. KEVIN FISCHER, PE
 PROJECT ENGINEER

 LETTING DATE:
 FEBRUARY 4, 2026

STRUCTURES ENGINEER

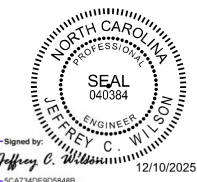
 Signed by: *Jeffrey C. Wilson* 12/10/2025
 SC0734029058488
 JEFFREY C. WILSON
 SIGNATURE:

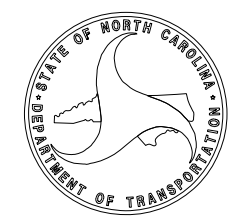

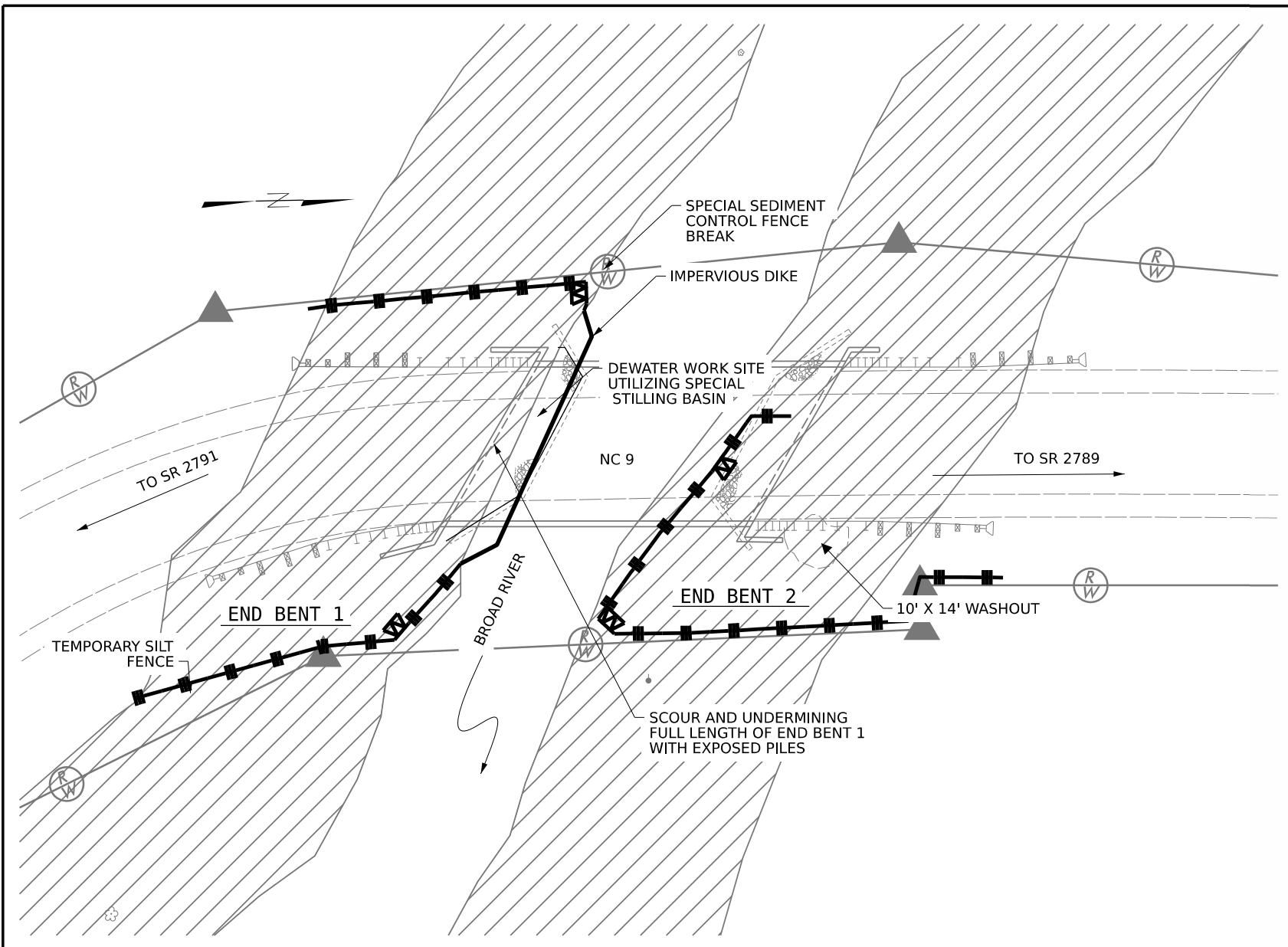

EROSION CONTROL SKETCH



 ENVIRONMENTALLY SENSITIVE AREA SEE PROJECT SPECIAL PROVISIONS	THIS PROJECT HAS BEEN DESIGNED TO SENSITIVE WATERSHED STANDARDS.	ENVIRONMENTALLY SENSITIVE AREA(S) EXIST ON THIS PROJECT <i>Refer To E.C. Special Provisions for Special Considerations.</i>
--	--	--

EC NOTES:

EROSION CONTROL SKETCH WAS NOT BASED ON ACTUAL SURVEY. CONTRACTOR TO FIELD VERIFY PLACEMENT OF PROPOSED EROSION CONTROL DEVICES AND QUANTITIES REQUIRED FOR THIS PROJECT.

PAY ITEM NO.	SEC. NO.	DESCRIPTION	QTY	UNIT
3656000000-E	876	GEOTEXTILE FOR DRAINAGE	95	SY
6000000000-E	1605	TEMPORARY SILT FENCE	365	LF
6006000000-E	1610	EROSION CONTROL STONE, CLASS A	35	TON
6012000000-E	1610	SEDIMENT CONTROL STONE	15	TON
6015000000-E	1615	TEMPORARY MULCHING	0.5	ACR
6018000000-E	1620	SEED FOR TEMPORARY SEEDING	100	LB
6021000000-E	1620	FERTILIZER FOR TEMPORARY SEEDING	0.5	TON
6024000000-E	1622	TEMPORARY SLOPE DRAINS	200	LF
6029000000-E	SP	SAFETY FENCE	260	LF
6036000000-E	1631	MATTING FOR EROSION CONTROL	6250	SY
6042000000-E	1632	1/4" HARDWARE CLOTH	75	LF
6070000000-N	1639	SPECIAL STILLING BASINS	1	EA
6084000000-E	1660	SEEDING AND MULCHING	0.5	ACR
6087000000-E	1660	MOWING	0.5	ACR
6090000000-E	1661	SEED FOR REPAIR SEEDING	50	LB
6093000000-E	1661	FERTILIZER FOR REPAIR SEEDING	0.25	TON
6096000000-E	1662	SEED FOR SUPPLEMENTAL SEEDING	50	LB
6108000000-E	1665	FERTILIZER TOPDRESSING	0.25	TON
6111000000-E	SP	IMPERVIOUS DIKE	65	LF
6114500000-N	1667	SPECIALIZED HAND MOWING	10	MHR
6117000000-N	1675	RESPONSE FOR EROSION CONTROL	13	EA
6117500000-N	SP	CONCRETE WASHOUT STRUCTURE	1	EA
6132000000-N	SP	GENERIC EROSION CONTROL ITEM - PREFABRICATED CONCRETE WASHOUT	2	EA

PROJECT NO. 18313.1011058.PR
BUNCOMBE COUNTY
 STATION: _____

STATE OF NORTH CAROLINA
 DEPARTMENT OF TRANSPORTATION
 RALEIGH
**REPAIRS FOR BRIDGE
 100079 ON NC 9 OVER
 BROAD RIVER BETWEEN
 SR 2791 AND SR 2798**

 VHB Engineering NC, P.C. (C-3705)
 940 Main Campus Drive, Suite 500
 Raleigh, NC 27606

DRAWN BY : GEORGIA REICHLING DATE : 12/2025
 CHECKED BY : J.R. HOPSON DATE : 12/2025
 DESIGN ENGINEER OF RECORD: _____ DATE : _____

REVISIONS						SHEET NO.
NO.	BY:	DATE:	NO.	BY:	DATE:	EC-1
1			3			TOTAL SHEETS
2			4			8

ONSITE CONCRETE WASHOUT STRUCTURE WITH LINER

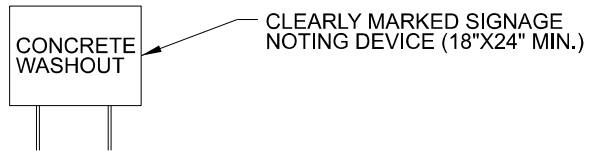
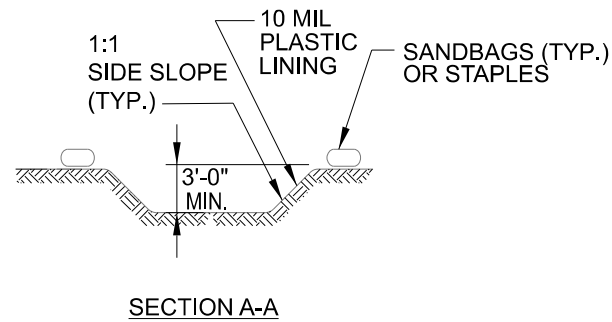
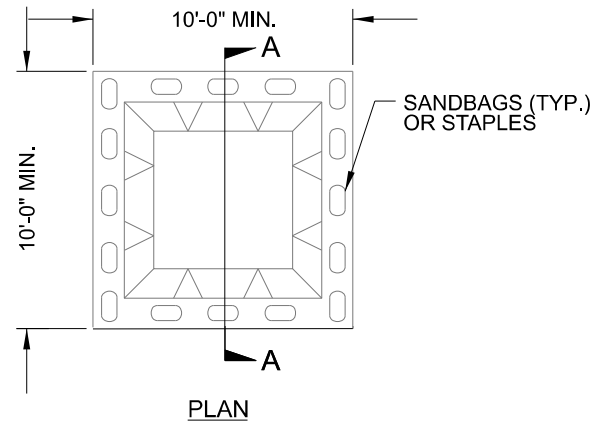

BELOW GRADE WASHOUT STRUCTURE
NOT TO SCALE

- NOTES:**
1. ACTUAL LOCATION DETERMINED IN FIELD
 2. THE CONCRETE WASHOUT STRUCTURES SHALL BE MAINTAINED WHEN THE LIQUID AND/OR SOLID REACHES 75% OF THE STRUCTURES CAPACITY TO PROVIDE ADEQUATE HOLDING CAPACITY WITH A MINIMUM 12 INCHES OF FREEBOARD.
 3. CONCRETE WASHOUT STRUCTURE NEEDS TO BE CLEARLY MARKED WITH SIGNAGE NOTING DEVICE.

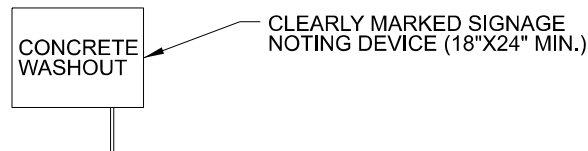
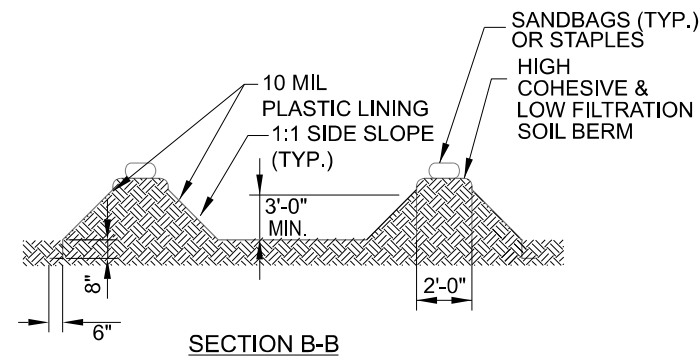
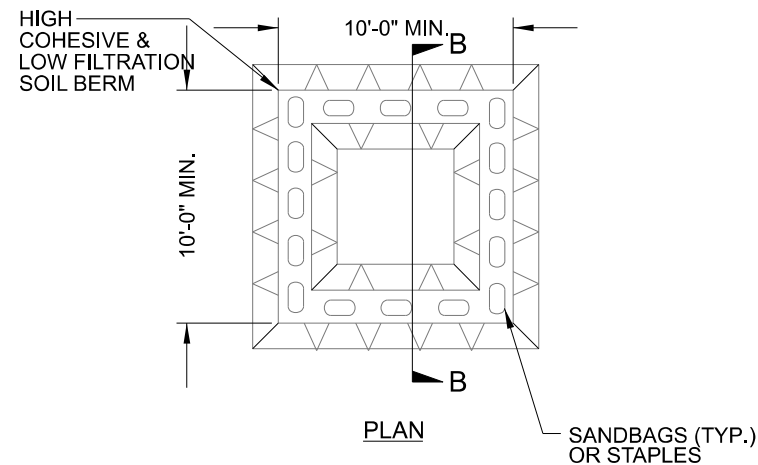

ABOVE GRADE WASHOUT STRUCTURE
NOT TO SCALE

- NOTES:**
1. ACTUAL LOCATION DETERMINED IN FIELD
 2. THE CONCRETE WASHOUT STRUCTURES SHALL BE MAINTAINED WHEN THE LIQUID AND/OR SOLID REACHES 75% OF THE STRUCTURES CAPACITY TO PROVIDE ADEQUATE HOLDING CAPACITY WITH A MINIMUM 12 INCHES OF FREEBOARD.
 3. CONCRETE WASHOUT STRUCTURE NEEDS TO BE CLEARLY MARKED WITH SIGNAGE NOTING DEVICE.

PROJECT NO. 18313.1011058.PR
BUNCOMBE COUNTY
STATION: _____

STATE OF NORTH CAROLINA
DEPARTMENT OF TRANSPORTATION
RALEIGH

**REPAIRS FOR BRIDGE
100079 ON NC 9 OVER
BROAD RIVER BETWEEN
SR 2791 AND SR 2798**

REVISIONS						SHEET NO.
NO.	BY:	DATE:	NO.	BY:	DATE:	EC-2
1			3			TOTAL SHEETS
2			4			8

vhb
VHB Engineering NC, P.C. (C-3705)
940 Main Campus Drive, Suite 500
Raleigh, NC 27606

DRAWN BY : GEORGIA REICHLING DATE : 12/2025
CHECKED BY : J.R. HOPSON DATE : 12/2025
DESIGN ENGINEER OF RECORD: _____ DATE : _____

DIVISION OF HIGHWAYS
STATE OF NORTH CAROLINA

SOIL STABILIZATION TIMEFRAMES

<i>SITE DESCRIPTION</i>	<i>STABILIZATION TIME</i>	<i>TIMEFRAME EXCEPTIONS</i>
PERIMETER DIKES, SWALES, DITCHES AND SLOPES	7 DAYS	NONE
HIGH QUALITY WATER (HQW) ZONES	7 DAYS	NONE
SLOPES STEEPER THAN 3:1	7 DAYS	IF SLOPES ARE 10' OR LESS IN LENGTH AND ARE NOT STEEPER THAN 2:1, 14 DAYS ARE ALLOWED.
SLOPES 3:1 TO 4:1	14 DAYS	7 DAYS FOR SLOPES GREATER THAN 50' IN LENGTH WITH SLOPES STEEPER THAN 4:1. 7 DAYS FOR PERIMETER DIKES, SWALES, DITCHES PERIMETER SLOPES, AND HQW ZONES
ALL OTHER AREAS WITH SLOPES FLATTER THAN 4:1	14 DAYS	7 DAYS FOR PERIMETER DIKES, SWALES, DITCHES PERIMETER SLOPES, AND HQW ZONES

PROJECT NO. 18313.1011058.PR
BUNCOMBE COUNTY
 STATION: _____



DRAWN BY : GEORGIA REICHLING DATE : 12/2025
 CHECKED BY : J.R. HOPSON DATE : 12/2025
 DESIGN ENGINEER OF RECORD: _____ DATE : _____

STATE OF NORTH CAROLINA
DEPARTMENT OF TRANSPORTATION
RALEIGH

REPAIRS FOR BRIDGE
100079 ON NC 9 OVER
BROAD RIVER BETWEEN
SR 2791 AND SR 2798

REVISIONS						SHEET NO.
NO.	BY:	DATE:	NO.	BY:	DATE:	EC-3
1			3			TOTAL SHEETS
2			4			8

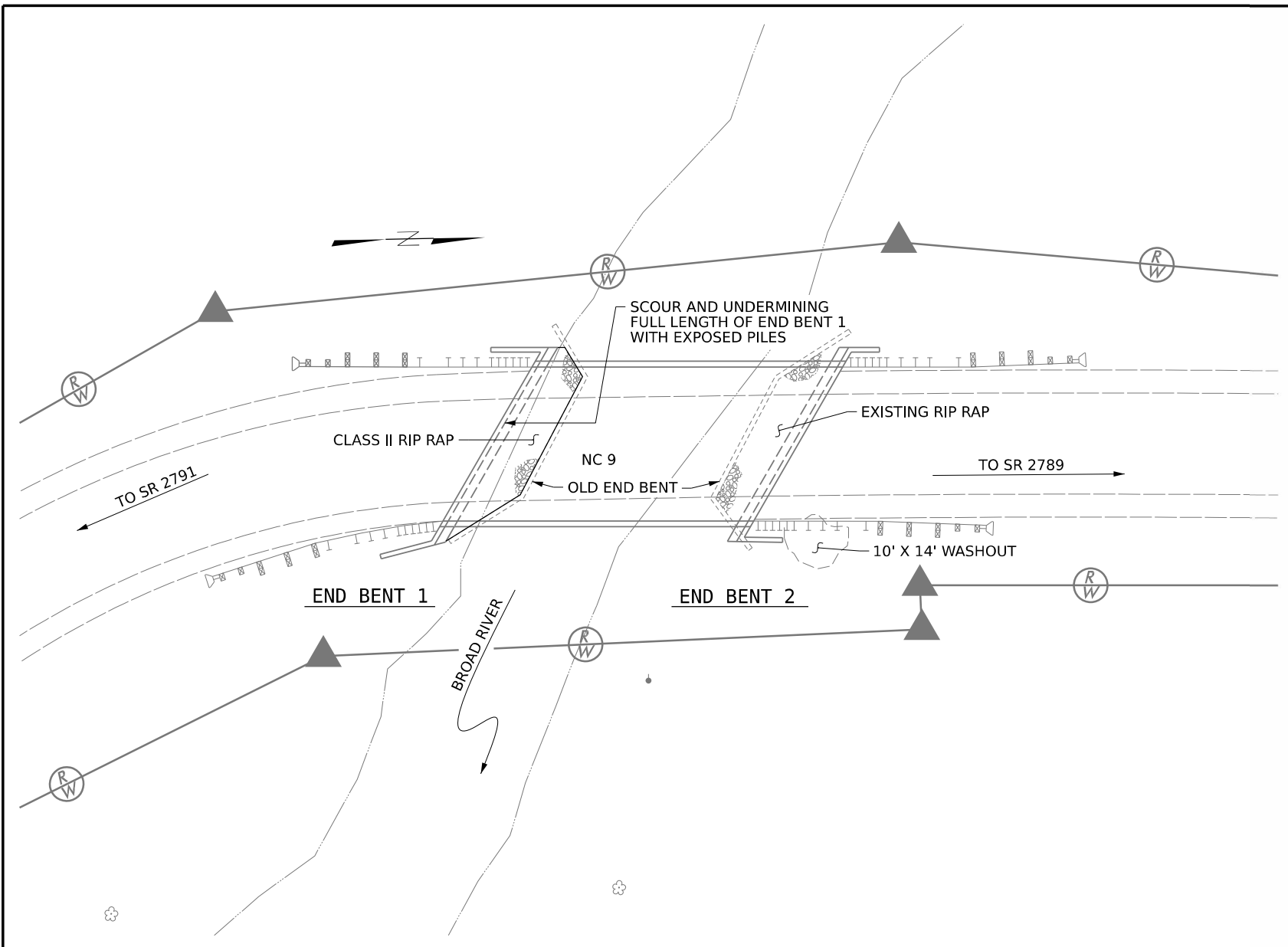

LOCATION SKETCH



SCOPE OF WORK

- INSTALL PILE ENCAPSULATION AT END BENT 1
- INSTALL FLOWABLE FILL AS NECESSARY TO FULLY COMPACT BEHIND AND UNDER THE PILE ENCAPSULATION
- FILL IN AREA BETWEEN END BENT AND OLD END BENT WITH NATIVE MATERIAL AND CLASS II RIP RAP
- REMOVE GUARDRAIL AND REPAIR WASH OUT AREA AT SOUTHEAST CORNER OF END BENT 2
- RESET GUARDRAILS

NOTE

EXISTING DIMENSIONS AND BRIDGE CONDITIONS ARE FROM BEST INFORMATION AVAILABLE; THE CONTRACTOR SHALL FIELD VERIFY THE INFORMATION SHOWN ON THE PLANS AND NOTIFY THE ENGINEER IF ACTUAL DIMENSIONS AND CONDITIONS DIFFER; THE CONTRACTOR SHALL HAVE NO CLAIM WHATSOEVER AGAINST THE DEPARTMENT OF TRANSPORTATION FOR ANY DELAYS OR ADDITIONAL COST INCURRED BASED ON DIFFERENCES BETWEEN THAT SHOWN ON THE PLANS AND THE ACTUAL CONDITIONS AT THE PROJECT SITE.

Line Item	Sec No.	Description	Quantity	Unit
0000100000-N	800	MOBILIZATION	1	LS
0194000000-E	265	SELECT GRANULAR MATERIAL, CLASS III	40	CY
0248000000-N	SP	GRADING	1	LS
1491000000-E	610	ASPHALT CONC BASE COURSE, TYPE B25.0C	1	Ton
1503000000-E	610	ASPHALT CONC INTERMEDIATE COURSE, TYPE I19.0C	2	Ton
1519000000-E	610	ASPHALT CONC SURFACE COURSE, TYPE S9.5B	2	Ton
1575000000-E	620	ASPHALT BINDER FOR PLANT MIX	2	Ton
2275000000-E	SP	FLOWABLE FILL	3	CY
3345000000-E	864	REMOVE & RESET EXISTING GUARDRAIL	50	LF
8121000000-N	412	UNCLASSIFIED STRUCTURE EXCAVATION	1	LS
8182000000-E	420	CLASS A CONCRETE (BRIDGE)	20.6	CY
8217000000-E	425	REINFORCING STEEL (BRIDGE)	948	LB
8608000000-E	876	RIP RAP II (2'-0")	20	TON
8622000000-E	876	GEOTEXTILE FOR DRAINAGE	25	SY

PROJECT NO. **18313.1011058.PR**
BUNCOMBE COUNTY
 STATION: _____



STATE OF NORTH CAROLINA
 DEPARTMENT OF TRANSPORTATION
 RALEIGH
**REPAIRS FOR BRIDGE
 100079 ON NC 9 OVER
 BROAD RIVER BETWEEN
 SR 2791 AND SR 2798**

DRAWN BY : D.B. HINNANT	DATE : 12/2025
CHECKED BY : K. FISCHER	DATE : 12/2025
DESIGN ENGINEER OF RECORD: J.C. WILSON	DATE : 12/2025

DOCUMENT NOT CONSIDERED
 FINAL UNLESS ALL
 SIGNATURES COMPLETED

REVISIONS						SHEET NO.
NO.	BY:	DATE:	NO.	BY:	DATE:	TOTAL SHEETS
1			3			8
2			4			8

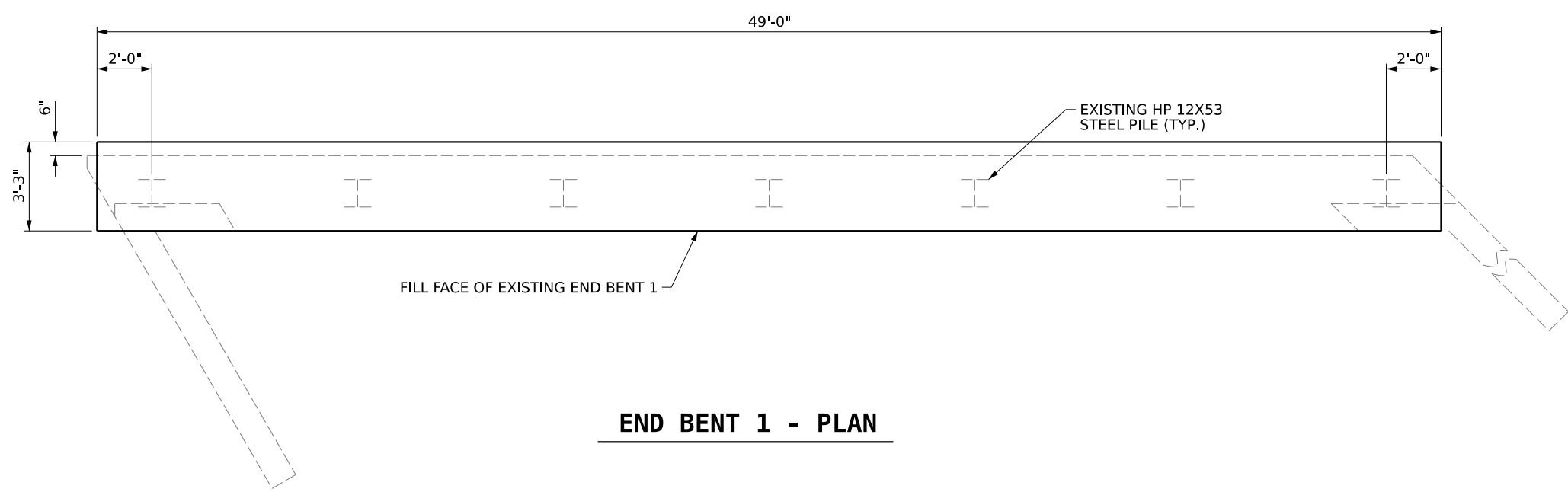

END BENT 1 - PLAN

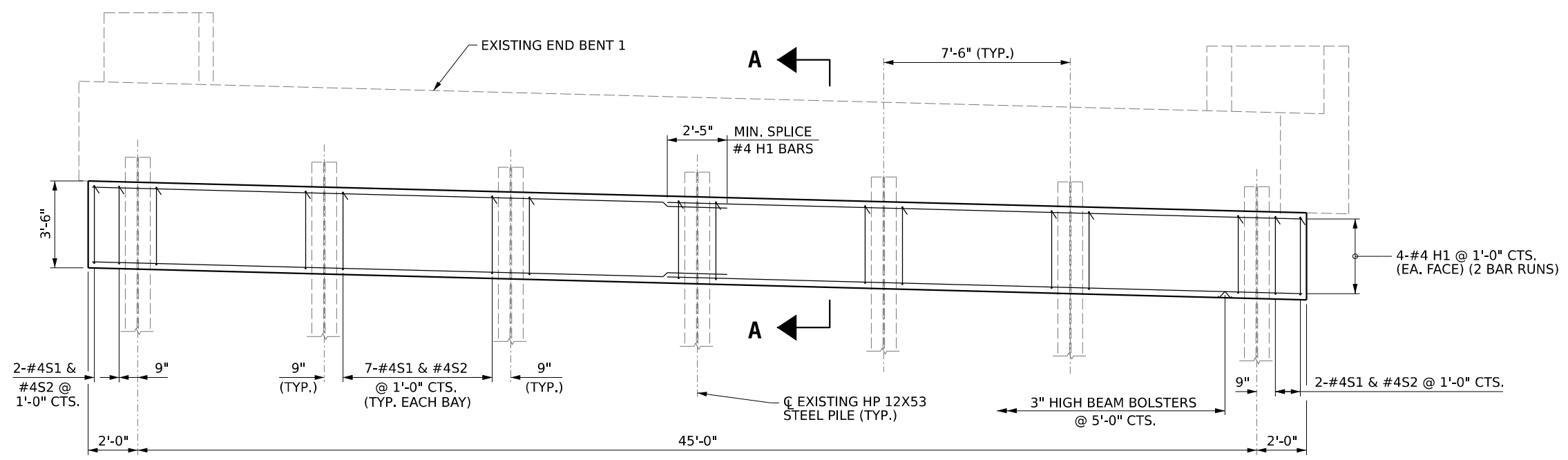

END BENT 1 - ELEVATION

WINGS NOT SHOWN FOR CLARITY

BAR TYPES		BILL OF MATERIAL				
		END BENT 1				
BAR NO	SIZE	TYPE	LENGTH	WEIGHT		
H1	#4	STR	25' - 7"	308		
S1	#4	1	9' - 11"	305		
S2	#4	2	3' - 8"	113		
REINFORCING STEEL				LBS.	726	
CLASS A CONCRETE				C.Y.	20.6	

ALL BAR DIMENSIONS ARE OUT TO OUT

NOTES

INSTALL FLOWABLE FILL AS NECESSARY TO FULLY COMPACT BEHIND AND UNDER THE PILE ENCAPSULATION

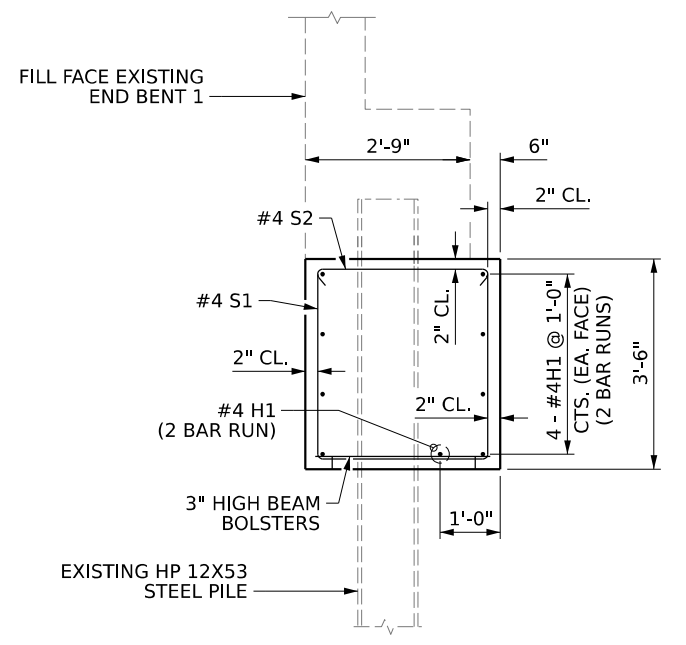

SECTION A-A

PROJECT NO. **18313.1011058.PR**
BUNCOMBE COUNTY
 STATION: _____



STATE OF NORTH CAROLINA
 DEPARTMENT OF TRANSPORTATION
 RALEIGH
**REPAIRS FOR BRIDGE
 100079 ON NC 9 OVER
 BROAD RIVER BETWEEN
 SR 2791 AND SR 2798**

DRAWN BY : D.B. HINNANT	DATE : 12/2025
CHECKED BY : K. FISCHER	DATE : 12/2025
DESIGN ENGINEER OF RECORD: J.C. WILSON	DATE : 12/2025

DOCUMENT NOT CONSIDERED FINAL UNLESS ALL SIGNATURES COMPLETED

REVISIONS						SHEET NO.
NO.	BY:	DATE:	NO.	BY:	DATE:	TOTAL SHEETS
1			3			5-2
2			4			8

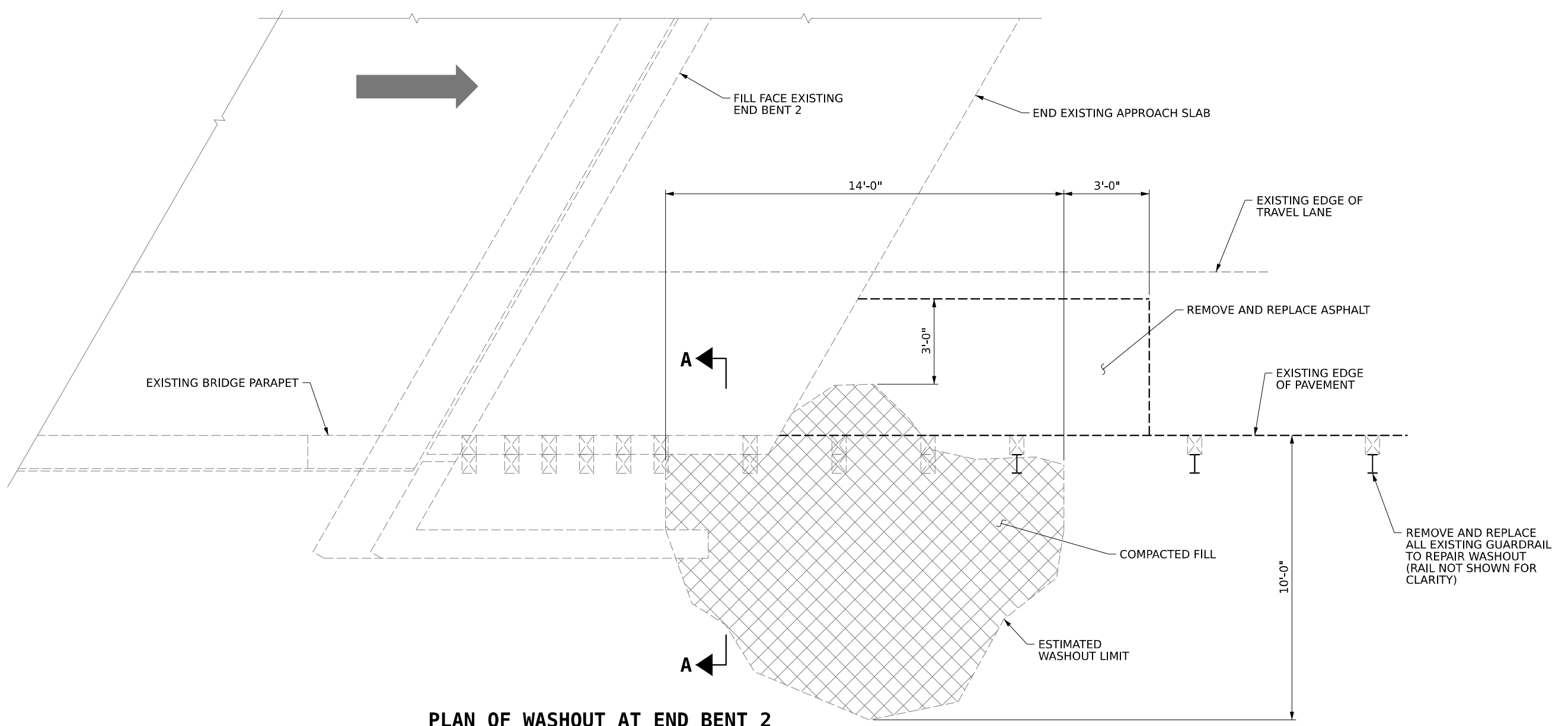

PLAN OF WASHOUT AT END BENT 2

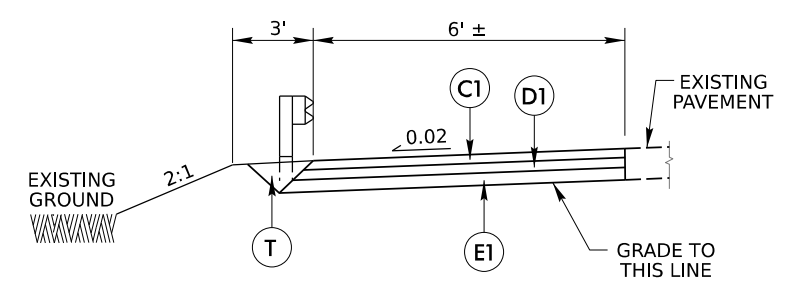

TYPICAL SECTION PAVEMENT
NOT TO SCALE

PAVEMENT SCHEDULE	
C1	3" S9.5C
D1	4" 19.0C,
E1	5" B25.0C,
T	EARTH MATERIAL

NOTE: PAVEMENT EDGE SLOPES ARE 1:1 UNLESS SHOWN OTHERWISE.

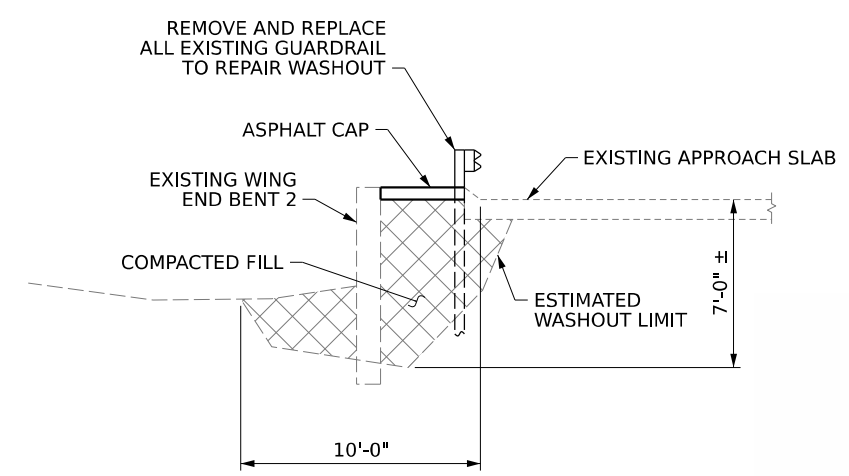

SECTION A-A

PROJECT NO. **18313.1011058.PR**
BUNCOMBE COUNTY
 STATION: _____



STATE OF NORTH CAROLINA
 DEPARTMENT OF TRANSPORTATION
 RALEIGH

REPAIRS FOR BRIDGE 100079 ON NC 9 OVER BROAD RIVER BETWEEN SR 2791 AND SR 2798

REVISIONS						SHEET NO.
NO.	BY:	DATE:	NO.	BY:	DATE:	TOTAL SHEETS
1			3			5-3
2			4			8

DOCUMENT NOT CONSIDERED FINAL UNLESS ALL SIGNATURES COMPLETED

vhb
 VHB Engineering NC, P.C. (C-3705)
 940 Main Campus Drive, Suite 500
 Raleigh, NC 27606

DRAWN BY : **D.B. HINNANT** DATE : **12/2025**
 CHECKED BY : **K. FISCHER** DATE : **12/2025**
 DESIGN ENGINEER OF RECORD: **J.C. WILSON** DATE : **12/2025**

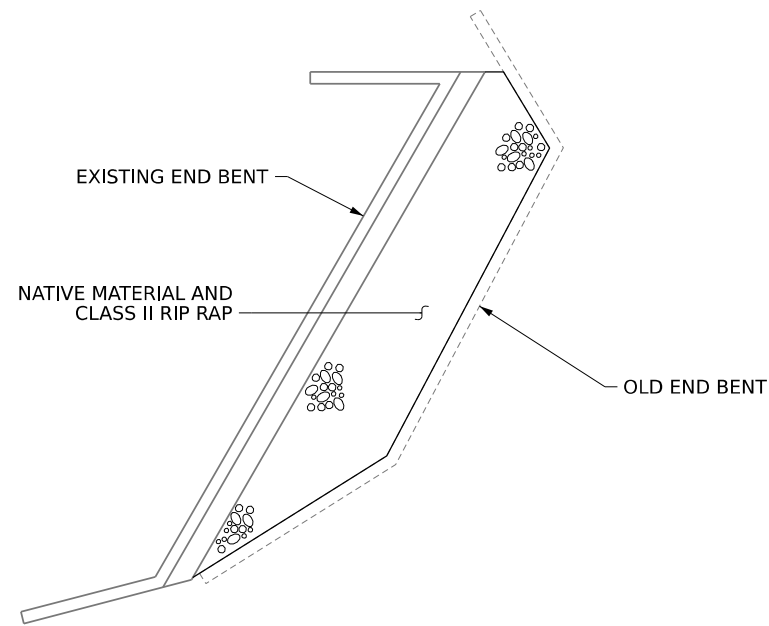

PLAN - END BENT 1

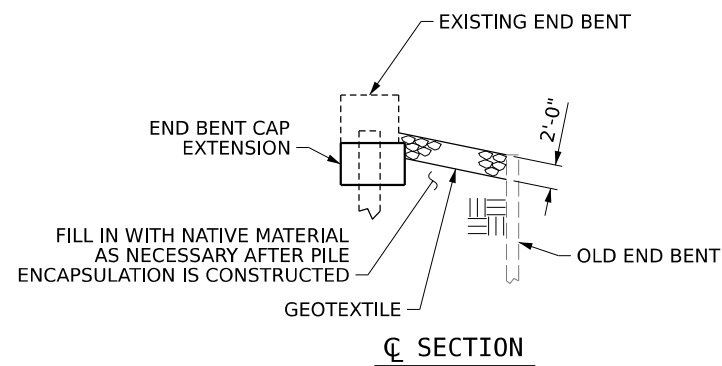

ESTIMATED QUANTITIES		
	RIP RAP CLASS II (2'-0" THICK)	GEOTEXTILE FOR DRAINAGE
	TONS	SQUARE YARDS
END BENT 1	20	25

PROJECT NO. 18313.1011058.PR
BUNCOMBE COUNTY
 STATION: _____



VHB Engineering NC, P.C. (C-3705)
 940 Main Campus Drive, Suite 500
 Raleigh, NC 27606

DRAWN BY : D.B. HINNANT DATE : 12/2025
 CHECKED BY : K. FISCHER DATE : 12/2025
 DESIGN ENGINEER OF RECORD: J.C. WILSON DATE : 12/2025

12/10/2025
 c:\bms\vhb-pw-01\d0272526\100079 Repair 07 RR S-04.dgn
 dhinnant



STATE OF NORTH CAROLINA
 DEPARTMENT OF TRANSPORTATION
 RALEIGH

**REPAIRS FOR BRIDGE
 100079 ON NC 9 OVER
 BROAD RIVER BETWEEN
 SR 2791 AND SR 2798**

DOCUMENT NOT CONSIDERED
 FINAL UNLESS ALL
 SIGNATURES COMPLETED

REVISIONS						SHEET NO.
NO.	BY:	DATE:	NO.	BY:	DATE:	
1			3			S-4
2			4			TOTAL SHEETS 8

MANAGEMENT STRATEGIES

THE FOLLOWING LISTED WORK ZONE STRATEGIES ARE RECOMMENDED FOR INCLUSION WITHIN THIS TRANSPORTATION MANAGEMENT PLAN (TMP).

RECOMMENDED STRATEGIES:

TRAFFIC MANAGEMENT STRATEGIES:

- LANE SHIFTS OR CLOSURES
- SHOULDER CLOSURES
- ONE-LANE, TWO WAY OPERATION (SIGNALIZED)

WORK ZONE SAFETY & MOBILITY STRATEGIES:

- AUTOMATED FLAGGER ASSISTANCE DEVICES (AFADS)

PHASING

MAINTAIN VEHICULAR ACCESS TO ALL RESIDENCES AND BUSINESSES DURING THE LIFE OF THE CONTRACT UNLESS OTHERWISE NOTED IN THE PHASING OR DIRECTED BY THE ENGINEER.

PHASE I

- STEP 1 - USING RSD 1101.01, SHEET 3 OF 3, INSTALL ADVANCE WARNING SIGNS.
- STEP 2 - USING USE RSD 1101.02, SHEET 17 OF 19; RSD 1101.04, SHEET 1 OF 2; OR RSD 1101.02, SHEET 1 OF 19 AS NEEDED, CLOSE THE SHOULDER OR TRAVEL LANE TO COMPLETE THE REPAIRS.
- STEP 3 - REMOVE ALL TEMPORARY TRAFFIC CONTROL DEVICES AND MARKINGS AND OPEN ALL LANES TO TRAFFIC.

GENERAL NOTES

CHANGES MAY BE REQUIRED WHEN PHYSICAL DIMENSIONS IN THE DETAIL DRAWINGS, STANDARD DETAILS, AND ROADWAY DETAILS ARE NOT ATTAINABLE TO MEET FIELD CONDITIONS OR RESULT IN DUPLICATE OR UNDESIRED OVERLAPPING OF DEVICES. MODIFICATION MAY INCLUDE: MOVING, SUPPLEMENTING, COVERING, OR REMOVAL OF DEVICES AS DIRECTED BY THE ENGINEER. THE FOLLOWING GENERAL NOTES APPLY AT ALL TIMES FOR THE DURATION OF THE CONSTRUCTION PROJECT EXCEPT WHEN OTHERWISE NOTED IN THE PLAN OR DIRECTED BY THE ENGINEER.

THE FOLLOWING GENERAL NOTES APPLY AT ALL TIMES FOR THE DURATION OF THE CONSTRUCTION PROJECT EXCEPT WHEN OTHERWISE NOTED IN THE PLAN OR DIRECTED BY THE ENGINEER.

LANE AND SHOULDER CLOSURE REQUIREMENTS

- A) REMOVE LANE CLOSURE DEVICES FROM THE LANE WHEN WORK IS NOT BEING PERFORMED BEHIND THE LANE CLOSURE OR WHEN A LANE CLOSURE IS NO LONGER NEEDED OR AS DIRECTED BY THE ENGINEER.
- B) WHEN PERSONNEL AND/OR EQUIPMENT ARE WORKING WITHIN 15 FT OF AN OPEN TRAVEL LANE, CLOSE THE NEAREST OPEN SHOULDER USING ROADWAY STANDARD DRAWING NO. 1101.04 UNLESS THE WORK AREA IS PROTECTED BY BARRIER OR GUARDRAIL OR A LANE CLOSURE IS INSTALLED.
- C) WHEN PERSONNEL AND/OR EQUIPMENT ARE WORKING WITHIN 5 FT OF AN OPEN TRAVEL LANE ON AN UNDIVIDED FACILITY, CLOSE THE NEAREST OPEN TRAVEL LANE USING ROADWAY STANDARD DRAWING NO. 1101.02 UNLESS THE WORK AREA IS PROTECTED BY BARRIER OR GUARDRAIL.
- WHEN PERSONNEL AND/OR EQUIPMENT ARE WORKING WITHIN 10 FT OF AN OPEN TRAVEL LANE ON A DIVIDED FACILITY, CLOSE THE NEAREST OPEN TRAVEL LANE USING ROADWAY STANDARD DRAWING NO. 1101.02 UNLESS THE WORK AREA IS PROTECTED BY BARRIER OR GUARDRAIL.
- D) WHEN PERSONNEL AND/OR EQUIPMENT ARE WORKING WITHIN A LANE OF TRAVEL OF AN UNDIVIDED OR DIVIDED FACILITY, CLOSE THE LANE ACCORDING TO THE TRAFFIC CONTROL PLANS, ROADWAY STANDARD DRAWINGS, OR AS DIRECTED BY THE ENGINEER. CONDUCT THE WORK SO THAT ALL PERSONNEL AND/OR EQUIPMENT REMAIN WITHIN THE CLOSED TRAVEL LANE.
- E) DO NOT WORK SIMULTANEOUSLY WITHIN 15 FT ON BOTH SIDES OF AN OPEN TRAVELWAY, RAMP, OR LOOP WITHIN THE SAME LOCATION UNLESS PROTECTED WITH GUARDRAIL OR BARRIER.
- F) USE SEQUENTIAL FLASHING WARNING LIGHTS ON DRUMS USED FOR THE MERGING TAPERS OF NIGHTTIME LANE CLOSURES IN ACCORDANCE WITH SECTION 1140 IN THE STANDARD SPECIFICATIONS FOR ROADS AND STRUCTURES.
- G) NOTIFY THE NCDOT STATEWIDE TRANSPORTATION OPERATIONS CENTER (STOC) AT 877-627-7862 APPROXIMATELY 30 MINUTES PRIOR TO INSTALLING AND WITHIN 15 MINUTES AFTER REMOVING LANE CLOSURES ON INTERSTATES, FREEWAYS, CONTROLLED ACCESS FACILITIES, AND US ROUTES.

PAVEMENT EDGE DROP OFF REQUIREMENTS

- H) BACKFILL AT A 6:1 SLOPE UP TO THE EDGE AND ELEVATION OF EXISTING PAVEMENT IN AREAS ADJACENT TO AN OPENED TRAVEL LANE THAT HAS AN EDGE OF PAVEMENT DROP-OFF AS FOLLOWS:
- BACKFILL DROP-OFFS THAT EXCEED 2 INCHES ON ROADWAYS WITH POSTED SPEED LIMITS OF 45 MPH OR GREATER.
- BACKFILL DROP-OFFS THAT EXCEED 3 INCHES ON ROADWAYS WITH POSTED SPEED LIMITS LESS THAN 45 MPH.



BACKFILL WITH SUITABLE COMPACTED MATERIAL, AS APPROVED BY THE ENGINEER, AT NO EXPENSE TO THE DEPARTMENT.

- I) DO NOT EXCEED A DIFFERENCE OF 2 INCHES IN ELEVATION BETWEEN OPEN LANES OF TRAFFIC FOR NOMINAL LIFTS OF 1.5 INCHES. INSTALL ADVANCE WARNING "UNEVEN LANES" SIGNS (W8-11) IN ADVANCE AND A MINIMUM OF EVERY HALF MILE THROUGHOUT THE UNEVEN AREA.

TRAFFIC PATTERN ALTERATIONS

- J) NOTIFY THE ENGINEER THIRTY (30) CALENDAR DAYS PRIOR TO ANY TRAFFIC PATTERN ALTERATION.

SIGNING

- K) INSTALL ADVANCE WORK ZONE WARNING SIGNS WHEN WORK IS WITHIN 40 FT FROM THE EDGE OF TRAVEL LANE AND NO MORE THAN THREE (3) DAYS PRIOR TO THE BEGINNING OF CONSTRUCTION.
- L) ENSURE ALL NECESSARY SIGNING IS IN PLACE PRIOR TO ALTERING ANY TRAFFIC PATTERN.

TRAFFIC CONTROL DEVICES

- M) WHEN LANE CLOSURES ARE NOT IN EFFECT SPACE CHANNELIZING DEVICES IN WORK AREAS NO GREATER IN FEET THAN TWICE THE POSTED SPEED LIMIT (MPH) EXCEPT, 10 FT ON-CENTER IN RADIUS, AND 3 FT OFF THE EDGE OF AN OPEN TRAVELWAY. REFER TO STANDARD SPECIFICATIONS FOR ROADS AND STRUCTURES SECTIONS 1130 (DRUMS), 1135 (CONES) AND 1180 (SKINNY DRUMS) FOR ADDITIONAL REQUIREMENTS.
- N) PLACE TYPE III BARRICADES, WITH "ROAD CLOSED" SIGN R11-2 ATTACHED, OF SUFFICIENT LENGTH TO CLOSE ENTIRE ROADWAY.

PAVEMENT MARKINGS AND MARKERS

- O) INSTALL TEMPORARY PAVEMENT MARKINGS AND TEMPORARY PAVEMENT MARKERS ON INTERIM LAYERS OF PAVEMENT AS FOLLOWS:

<u>ROAD NAME</u>	<u>MARKING</u>	<u>MARKER</u>
ALL ROADS	PAINT	NONE

- P) TIE PROPOSED PAVEMENT MARKING LINES TO EXISTING PAVEMENT MARKING LINES.
- Q) REMOVE/REPLACE ANY CONFLICTING/DAMAGED PAVEMENT MARKINGS AND MARKERS BY THE END OF EACH DAY'S OPERATION.

<u>Pay Item No.</u>	<u>Sec No.</u>	<u>Description</u>	<u>Quantity</u>	<u>Unit</u>
4400000000-E	1110	WORK ZONE SIGNS (STATIONARY)	48	SF
4405000000-E	1110	WORK ZONE SIGNS (PORTABLE)	188	SF
4415000000-N	1115	FLASHING ARROW BOARD	1	EA
4420000000-N	1120	PORTABLE CHANGEABLE MESSAGE SIGN	1	EA
4424500000-N	SP	TEMPORARY PORTABLE TRAFFIC SIGNAL SYSTEM	1	EA
4430000000-N	1130	DRUMS	50	EA
4455000000-N	1150	FLAGGER	10	DAY

PROJECT NO. 18313.1011058.PR
BUNCOMBE COUNTY
 STATION: _____



STATE OF NORTH CAROLINA
 DEPARTMENT OF TRANSPORTATION
 RALEIGH

REPAIRS FOR BRIDGE 100079 ON NC 9 OVER BROAD RIVER BETWEEN SR 2791 AND SR 2798

DRAWN BY : <u>J. TOWNSEND</u>	DATE : <u>12/2025</u>
CHECKED BY : <u>K. FISCHER</u>	DATE : <u>12/2025</u>
DESIGN ENGINEER OF RECORD: <u>J. TOWNSEND</u>	DATE : <u>12/2025</u>

DOCUMENT NOT CONSIDERED FINAL UNLESS ALL SIGNATURES COMPLETED					
REVISIONS					
NO.	BY:	DATE:	NO.	BY:	DATE:
1			3		
2			4		

SHEET NO.
TC-1
TOTAL SHEETS
8